

- GROUND FLOOR LEVEL MARKED AS +00, SHALL BE READ AS +100.60 WRT MASTER PLAN LAYOUT, (IIT NO. 17009-MP-S6-MP-001)
- ALL OTHER FLOOR LEVEL SHALL BE READ WRT TO GROUND FLOOR LEVEL

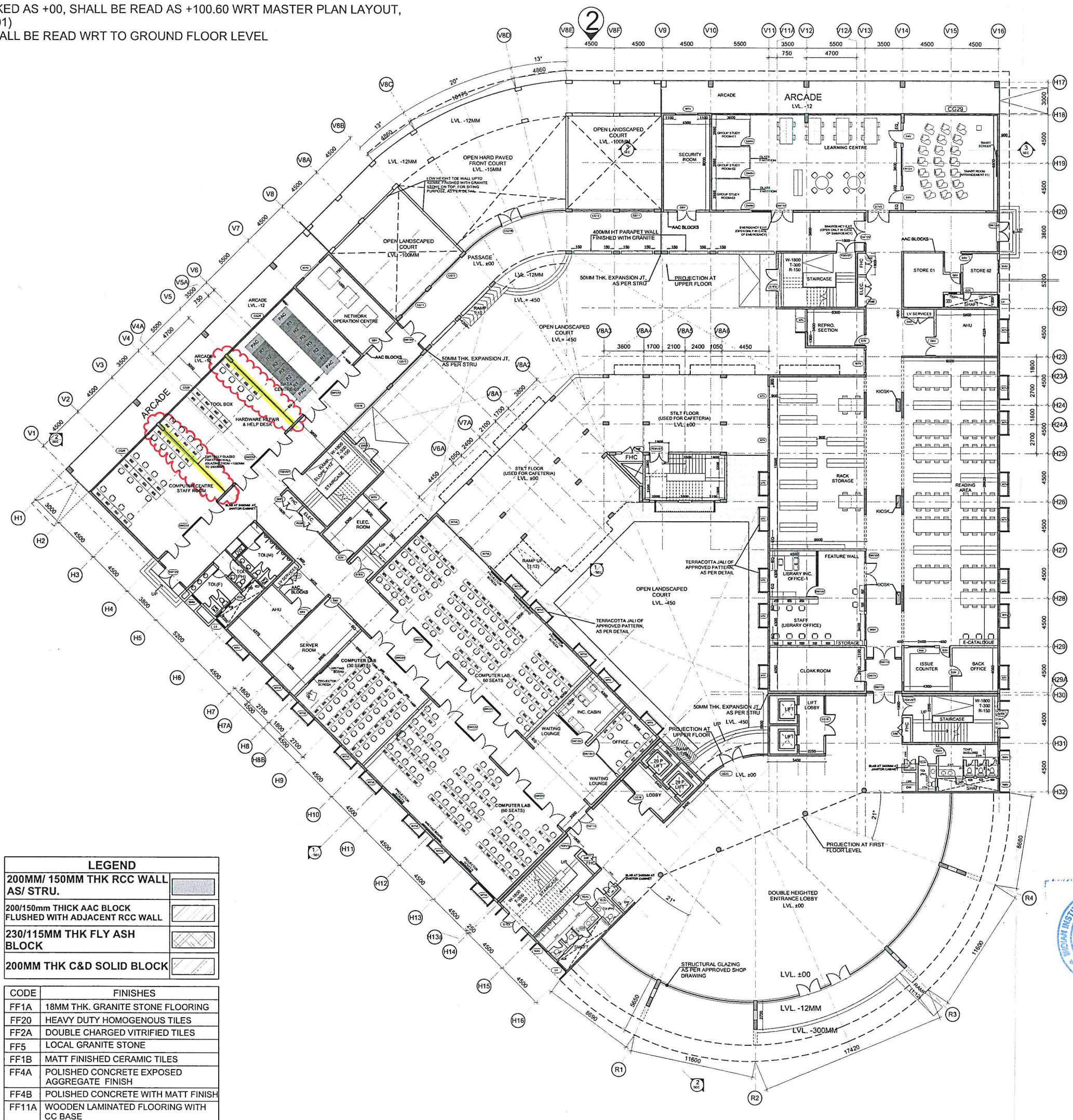

MARK	WIDTH	HT.	SILL	LINTEL
D2S	750	2275	125	2400
TD1	750	2400	00	2400
TD2V	900	2400	00	2400
TD3V	1000	2400	00	2400
D3V	1000	2400	00	2400
D4V	1200	2400	00	2400
D6E	1800	2275	125	2400
D6E1	1800	2275	125	2400
D6V	1800	2400	00	2400
FD6VST	1800	2400	00	2400
D6Ex	2100	2400	00	2400
D7V1	2100	2400	00	2400
D7V2	2100	2400	00	2400
D7EX	2100	2400	00	2400
DW7V	2100	2400	00/+125	2400
DW9V	2100	2400	00/+125	2400
DW10V	3000	2400	00/+125	2400
DW11V	3300	2400	00/+125	2400
DW12V	3600	2400	00/+125	2400
DW12V1	3600	2400	00/+125	2400
DW13V	3900	2400	00/+125	2400
DW14V	4200	2400	00/+125	2400
DW22V	6600	2400	00	2400

MARK	WIDTH	HT.	SILL	LINTEL
W3V	900	1500	900	2400
W4V	1200	1500	900	2400
W6V	1800	1500	900	2400
W7V	2100	1500	900	2400
W7VL	2100	1350	1050	2400
W7V1	2100	2700	900	B.O.B
W8V	2400	1500	900	2400
W8A	2400	1200	1200	2400
W12V	3600	1500	900	2400

CODE	FINISHES
FF1A	18MM THK. GRANITE STONE FLOORING
FF20	HEAVY DUTY HOMOGENOUS TILES
FF2A	DOUBLE CHARGED VITRIFIED TILES
FF5	LOCAL GRANITE STONE
FF1B	MATT FINISHED CERAMIC TILES
FF4A	POLISHED CONCRETE EXPOSED AGGREGATE FINISH
FF4B	POLISHED CONCRETE WITH MATT FINISH
FF11A	WOODEN LAMINATED FLOORING WITH CC BASE

MARK	WIDTH	HT.	SILL	LINTEL
V2A	800	900	1500	2400
V4	1200	900	1500	2400
L4/L4A	1200	3600	00	3600

MARK	WIDTH	HT.	SILL	LINTEL
CG11A	3300	3475	+125	B0B/3600
CG13	3900	3475	+125	B0B/3600
CG18	5600	3475	+125	B0B/3600
CG22A	6600	3600	00/+125	B0B/3600
CG28A	8350	3475	+125	B0B/3600

- NOTE:-
- THIS PLAN SHALL BE READ IN CONJUNCTION WITH ARCHITECTURAL DETAIL DRAWING & OTHER SERVICES DRAWING.
 - FOR FINISHES, REFER FINISHING SCHEDULE.
 - METAL DOOR, OF APPROVED SPECIFICATION & SHADE, SHALL BE INSTALLED WHEREVER SPECIFIED.
 - ALUMINIUM WINDOWS, WITH POWDER COATING OF APPROVED SHADE, SHALL BE INSTALLED WHEREVER SPECIFIED.
 - THE FURNITURE SHOWN IN LAYOUT PLAN IS SCHEMATIC & SHALL BE FIXED AS PER APP. MAKE & PATTERN.
 - FOR STAIRCASES, TOILET, RAMP, LIFT, DOOR-WINDOW GLAZING REFER INDIVIDUAL DETAIL.
 - IN TOILET BLOCK, FLYASH BRICKS SHALL BE USED.
 - FOR DOOR-WINDOW, GLAZING, FIXING OF POLYCARBONATE SHEET, TERRACOTA LOUVERS/ JALI FIXING ETC, PRIOR TO EXECUTION, SHOP DRAWING SHALL BE PREPARED BY CONTRACTOR & GOT IT APPROVED BY ARCHITECT/ CLIENT BEFORE EXECUTION.
 - FOR INTERNAL FINISHES, PRIOR TO EXECUTION, MOCK-UP SAMPLE SHALL BE MADE FIRST FOR APPROVAL FROM ARCHITECT/ CLIENT.
 - CAPACITY OF TERRACE TANK SHALL BE COORDINATED WITH PLUMBING DRAWINGS.
 - THE PERIPHERAL RCC SHEAR WALLS/ COLUMN ALONG WITH MARKED INTERNAL COLUMNS, AS PER STRUCTURE, SHALL BE RAISED +3750MM FROM TERRACE LEVEL TO SUPPORT THE FRAMING FOR SOLAR PANEL.
 - PROVISION OF TACTILE TILES SHALL BE MADE IN COMMON AREAS, AS PER FLOORING PLAN.
 - FOR STAIRCASE GLAZING PROFILE, REFER INDIVIDUAL STAIRCASE DETAIL.
 - FOR EXTERNAL CONNECTING PATHWAYS/ ROADS, RAMPS ETC, REFER EXTERNAL DEVELOPMENT DRAWING OF INDIVIDUAL BUILDING.

DATE	REV.	REV. BY	REMARKS
04.09.2021	R2	RJ	AS PER SITE VISIT & THEREAFTER IT DECISIONS DATED 20.08.21 TOILET ON GROUND FLOOR AT GRID NO. H5-H6 V1-V3 ADDED IN PLACE OF STAIRS PARTITION WALL DETAILS SHOWN LEGEND FOR DOOR WINDOWS DRAWING MODIFIED AT GRID H15-H16 V1-V2 AND H13-H14 V14-V16 TOILET BLOCK MODIFIED & PH TOILET ADDED AT GROUND FLOOR LEVEL JANITOR ROOM ADDED IN MALE TOILETS ON FIRST, SECOND & THIRD FLOOR LEVEL.
30.11.2019	R1	RJ	1. MODIFIED IN COMPLIANCE WITH FIRE APPROVAL REF. FIRE DEPT. LETTER DATED: 09.09.2018 * AT FIRST & SECOND FLOOR, ENTRY TO 02 NO. ROOM AT GRID V10-V11 & V12 SHIFTED TO PASSAGE. * 01 NO STAIRCASE & FHC ADDED IN CENTRAL FACULTY WING. 2. REF. ROOM DATED 18.11.2018 11.19. BY IIT TIRUPATI INTERNAL ASSESSMENT OVER SUBMITTED DRAWING, IN CENTRAL FACULTY WING, ON UPPER FLOOR, THE 02 NO. INTERMEDIATE VERTICAL PROJECTED FIN. TOWARDS WINDOW SIDE, BETWEEN 02 FACULTY ROOMS, SIDE BY SIDE, IS OMITTED AND COMBINED IN FACULTY ROOM. LARGO OTHER AREAS, FINISH EAST & WEST DIRECTION, THE TERRACOTA LOUVERS/ JALI IS EXTENDED FOR ENTIRE FACIAD. REF. ELEVATION. 3. IN FACULTY WING, THE 02 RAILING IS REPLACED WITH WINDOW HAVING OPENABLE SHUTTER PROVISION.

REVISIONS

PHE & FIRE FIGHTING SUB CONSULTANT :

Er. A.K. Roy | SGA
Email: mail@sgadesignlab.com
ravi@sgadesignlab.com

HVAC SUB CONSULTANT :

Er. Ajay Raj | SGA
Email: mail@sgadesignlab.com,
ravi@sgadesignlab.com

ELECTRICAL SUB CONSULTANT :

Er. S Singh, | SGA
Email: mail@sgadesignlab.com,
ravi@sgadesignlab.com

STRUCTURAL SUB CONSULTANT

JEHOVAHKING ENGINEERING CONSULTANTS PVT. LTD.
Guindy, Chennai - 600 032
Phone: +91 44 22500120

ARCHITCTS

SURESH GOEL & ASSOCIATES
ARCHITECTS ENGINEERS PLANNERS
C-45, SHIVALIK, NEW DELHI-110017
TEL: (011) 41034450, 26676254. MAIL: mail@sgadesignlab.com

EXECUTING AGENCY

C.P.W.D., IIT TIRUPATI PROJECTS DIVISION,
ANDHRA PRADESH

CLIENT

INDIAN INSTITUTE OF TECHNOLOGY, TIRUPATI
YERPEDU, ANDHRA PRADESH - 577619

STRUCTURE PROOF CHECKED BY IIT MADRAS

Dr. DEVDAS MENON (Professor)
Department of Civil Engineering,
Indian Institute of Technology Madras
Chennai - 600 036, India

PROJECT TITLE :

**DESIGN PACKAGE 1
PHASE-1(STAGE-1C), IIT TIRUPATI**

STAGE

GOOD FOR CONSTRUCTION

BUILDING TYPE:

DEPARTMENT BLOCK-02

DRAWING TITLE

GROUND FLOOR PLAN

DRAWING No.

17009-A3-S6-AP-001

DRAWN BY : AK	CHECKED BY : ST	APPROVED BY : RJ
SCALE A1= 1:200	Revision R2	Issue Date 20.07.19(R0)





- NOTE :-**
- THIS PLAN SHALL BE READ IN CONJUNCTION WITH ARCHITECTURAL DETAIL DRAWING & OTHER SERVICES DRAWING.
 - FOR FINISHES, REFER FINISHING SCHEDULE.
 - METAL DOOR, OF APPROVED SPECIFICATION & SHADE, SHALL BE INSTALLED WHEREVER SPECIFIED.
 - ALUMINIUM WINDOWS, WITH POWDER COATING OF APPROVED SHADE, SHALL BE INSTALLED WHEREVER SPECIFIED.
 - THE FURNITURE SHOWN IN LAYOUT PLAN IS SCHEMATIC & SHALL BE FIXED AS PER APP. MAKE & PATTERN.
 - FOR STAIRCASES, TOILET, RAMP, LIFT, DOOR-WINDOW GLAZING REFER INDIVIDUAL DETAIL.
 - IN TOILET BLOCK, FLYASH BRICKS SHALL BE USED.
 - FOR DOOR-WINDOW, GLAZING, FRAMING OF POLYCARBONATE SHEET, TERRACOTA LOUVERS/ JALI FRAMING ETC, PRIOR TO EXECUTION, SHOP DRAWING SHALL BE PREPARED BY CONTRACTOR & GOT IT APPROVED BY ARCHITECT/ CLIENT BEFORE EXECUTION.
 - FOR INTERNAL FINISHES, PRIOR TO EXECUTION, MOCK-UP SAMPLE SHALL BE MADE FIRST FOR APPROVAL FROM ARCHITECT/ CLIENT.
 - CAPACITY OF TERRACE TANK SHALL BE COORDINATED WITH PLUMBING DRAWINGS.
 - THE PERIPHERAL RCC BEAR WALLS/ COLUMN ALONG WITH MARKED INTERNAL COLUMNS, AS PER STRUCTURE, SHALL BE RAISED +3700MM FROM TERRACE LEVEL, TO SUPPORT THE FRAMING FOR SOLAR PANEL.
 - PROVISION OF TACTILE TILES SHALL BE MADE IN COMMON AREAS, AS PER FLOORING PLAN.
 - FOR STAIRCASE GLAZING PROFILE, REF. INDIVIDUAL STAIRCASE DETAIL.
 - FOR EXTERNAL CONNECTING PATHWAYS/ ROADS, RAMP ETC, REF. EXTERNAL DEVELOPMENT DRAWING OF INDIVIDUAL BUILDING.

DATE	REV.	REV. BY	REMARKS
04.08.2021	R0	RJ	AS PER SITE VISIT & THEREAFTER IT DECISION DATED 04.08.21 PLACE OF TOILET ON SECOND FLOOR AT GRID NO. H4-H5-V14 ACCORDING TO PLAN SHALL BE MAINTAINED.
18.10.2020	R2	ST	REF. PVT RECEIVED DATED 18.10.20 FROM IITP.
30.11.2019	R1	RJ	1. RECEIVED IN COMPLIANCE WITH PRA APPROVAL, REF. PRA DPT. LETTER DATED 30.11.2019. 2. AS PER IITP APPROVAL, ENTRY TO NO. 100 ROOM AT GRID V14 & V15 IS TO BE MAINTAINED. 3. IN NO. 100 ROOM, A JALI SHALL BE PROVIDED IN CENTRAL FACILITY WALL & JALI SHALL BE 1500MM X 1500MM, BY FT TRIPARTI INTERIOR. JALI SHALL BE 1500MM X 1500MM, BY FT TRIPARTI INTERIOR. FACILITY WALL ON UPPER FLOOR, THE JALI SHALL BE 1500MM X 1500MM, BY FT TRIPARTI INTERIOR. IN FACILITY ROOM, LIFT & OTHER AREAS, JALI SHALL BE 1500MM X 1500MM, BY FT TRIPARTI INTERIOR. IN FACILITY ROOM, THE TERRACOTA LOUVERS JALI IS EXTENDED FOR ENTRY FLOOR, REF. IITP APPROVAL. 4. IN FACILITY ROOM, THE JALI SHALL BE REPLACED WITH MEDIUM FRAME OPERABLE SHUTTER PROVIDED.

REVISIONS

PHE & FIRE FIGHTING SUB CONSULTANT :
Er. A.K. Roy | SGA
 Email: mail@gagedeignlab.com
 rvl@gagedeignlab.com

HVAC SUB CONSULTANT :
Er. Ajay Raj | SGA
 Email: mail@gagedeignlab.com,
 rvl@gagedeignlab.com

ELECTRICAL SUB CONSULTANT :
Er. S. Singh, | SGA
 Email: mail@gagedeignlab.com,
 rvl@gagedeignlab.com

STRUCTURAL SUB CONSULTANT
JEEVAHAKING ENGINEERING CONSULTANTS PVT. LTD.
 Guindy, Chennai - 600 032
 Phone: +91 44 22601120

ARCHITECTS
SURESH GOEL & ASSOCIATES
 ARCHITECTS - ENGINEERS PLANNERS
 C-06, BHVAIK, NEW DELHI-110017
 TEL: (011) 4104400, 28570254, MAIL:mail@gagedeignlab.com

EXECUTING AGENCY
C.P.W.D., IT TIRUPATI PROJECTS DIVISION, ANDHRA PRADESH

CLIENT
INDIAN INSTITUTE OF TECHNOLOGY, TIRUPATI
 YERPEDU, ANDHRA PRADESH - 577619

STRUCTURE PROOF CHECKED BY IIT MADRAS
Dr. DEVDAS MENON (Professor)
 Department of Civil Engineering,
 Indian Institute of Technology Madras
 Chennai - 600 036, India

PROJECT TITLE :
DESIGN PACKAGE 1
PHASE-1(STAGE-1C), IIT TIRUPATI

STAGE
GOOD FOR CONSTRUCTION

BUILDING TYPE:
DEPARTMENT-02 BLOCK

DRAWING TITLE
SECOND FLOOR PLAN

DRAWING No.
17009-A3-S6-AP-003

DRAWN BY : AK	CHECKED BY : ST	APPROVED BY : RJ
SCALE A1= 1:200	Revision R3	Issue Date 20.07.19

SCHEDULE OF DOOR

MARK	WIDTH	HT.	BILL	LINTEL
D2S	750	2275	125	2400
TD1	750	2400	00	2400
TD2V	900	2400	00	2400
TD3V	1000	2400	00	2400
D3V	1000	2400	00	2400
D4V	1200	2400	00	2400
D6E	1800	2275	125	2400
D6E1	1800	2275	125	2400
D6V	1800	2400	00	2400
FD6VST	1800	2400	00	2400
D6Ex	2100	2400	00	2400
D7V1	2100	2400	00	2400
D7V2	2100	2400	00	2400
D7EX	2100	2400	00	2400
DW7V	2100	2400	00/+125	2400
DW8V	2100	2400	00/+125	2400
DW10V	3000	2400	00/+125	2400
DW11V	3300	2400	00/+125	2400
DW12V	3600	2400	00/+125	2400
DW12V1	3600	2400	00/+125	2400
DW13V	3600	2400	00/+125	2400
DW14V	4200	2400	00/+125	2400
DW22V	6800		00	

SCHEDULE OF WINDOWS

MARK	WIDTH	HT.	BILL	LINTEL
W3V	900	1500	900	2400
W4V	1200	1500	900	2400
W6V	1800	1500	900	2400
W7V	2100	1500	900	2400
W7VL	2100	1350	1050	2400
W7V1	2100	2700	900	B.O.B
W8V	2400	1500	900	2400
W8A	2400	1200	1200	2400
W12V	3600	1500	900	2400

SCHEDULE OF VENTILATOR

MARK	WIDTH	HT.	BILL	LINTEL
V2A	900	900	1500	2400
V4	1200	900	1500	2400
L4/L4A		3600	00	3600

SCHEDULE OF CURTAIN GLAZING

MARK	WIDTH	HT.	BILL	LINTEL
CG11A	3300	3475	+125	BOB/3600
CG13	3600	3475	+125	BOB/3600
CG18	5600	3475	+125	BOB/3600
CG22A	6800	3800	00/+125	BOB/3600
CG28A	8350	3475	+125	BOB/3600
CG29	8700	2700	+900	BOB/3600
LG18	5400	2400	00/+125	2400

LEGEND

200MM/ 150MM THK RCC WALL AS/ STRU.	
200/150mm THK AAC BLOCK FLUSHED WITH ADJACENT RCC WALL.	
230/115MM THK FLY ASH BLOCK	
200MM THK C&D SOLID BLOCK	

CODE FINISHES

CODE	FINISHES
FF1A	18MM THK GRANITE STONE FLOORING
FF20	HEAVY DUTY HOMOGENOUS TILES
FF2A	DOUBLE CHARGED VITRIFIED TILES
FF5	LOCAL GRANITE STONE
FF1B	MATT FINISHED CERAMIC TILES
FF4A	POLISHED CONCRETE EXPOSED AGGREGATE FINISH
FF4B	POLISHED CONCRETE WITH MATT FINISH
FF11A	WOODEN LAMINATED FLOORING WITH CC BASE

CSE DEPARTMENT
EE DEPARTMENT

